

B30

50+53

46+76 Just over mt # 25 Center 33^d of
City Entry, on Washing lin. are
Locating mt 'B' South line
Thursday AM. March 6th 1890

Note: This mt B is about
20 feet under ground
100 feet mt @ line street. Am

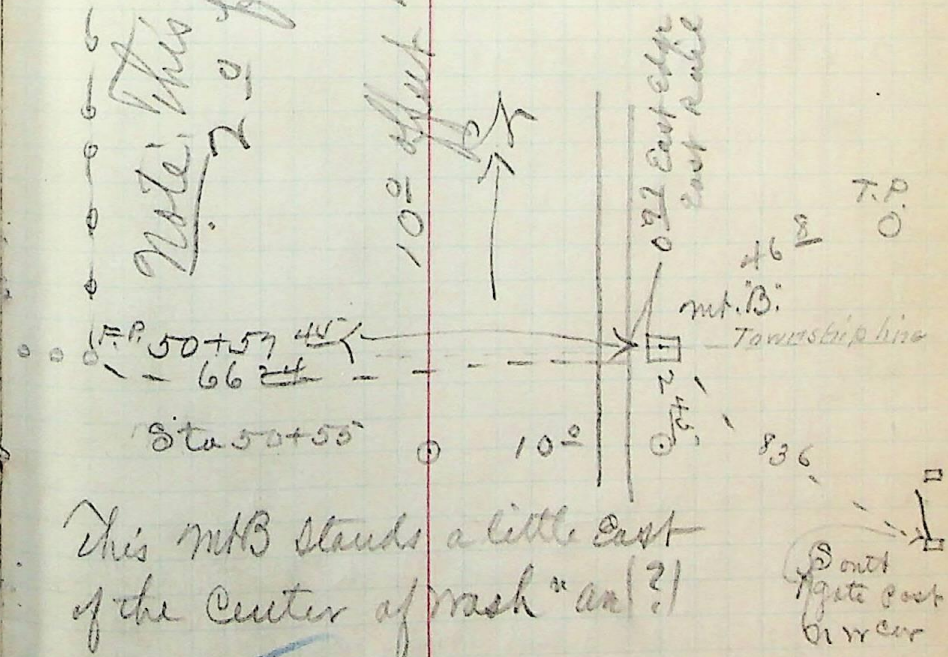

This mt B stands a little east
of the Center of wash "an" (?)

B30